

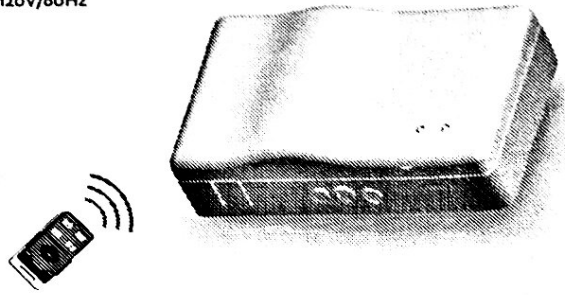

All controls support 433MHz & 868MHz
All controls support 230V/50Hz & 120V/60Hz

Control System

DC138 Control System Specification



Version No. : A/00

T Technical Support

Receiver specification



group control channel match code, delete code, all unworkable. When receiver in the mode of dot function, press up key or down key within two seconds, emitter control the motor working in dot function. If continuous press more than 2 seconds motor will last working.

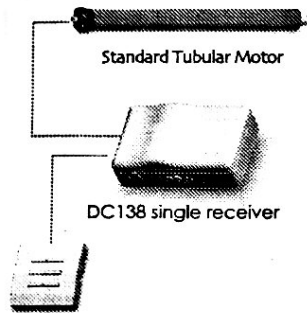

- × Dial reversing function
- × Dial switch over mode
- × Connecting with Electronic switch is available (company matched)
- × standard type DC138 can store 20 effective channels, over 20 channels, if still add new channel, only last channel will be repeating

Control Range

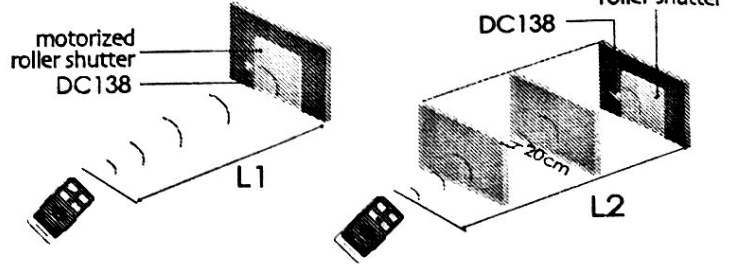

	L1 Open	L2 Partition	Emission frequency
230V/50Hz	200m	35m	433.92MHz
120V/60Hz	200m	35m	

T Technical Support

Matchable emitter



5-channel emitter = single channel emitter x 5
one channel of emitter can control 20 receivers at most

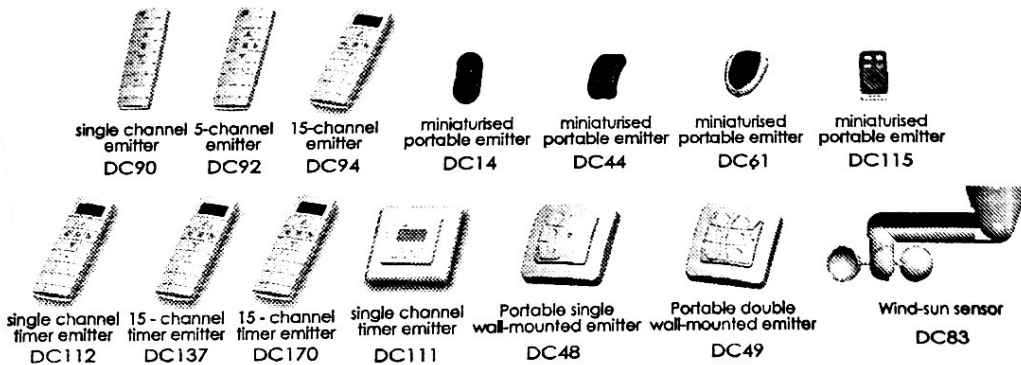

Button specification

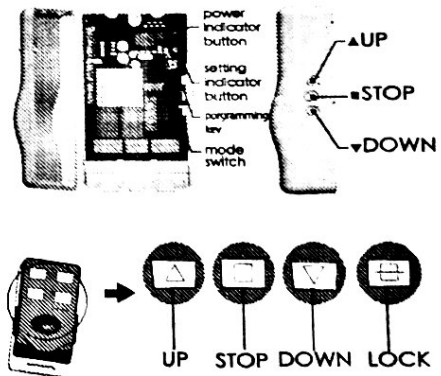

T Technical Support

Circuit installation

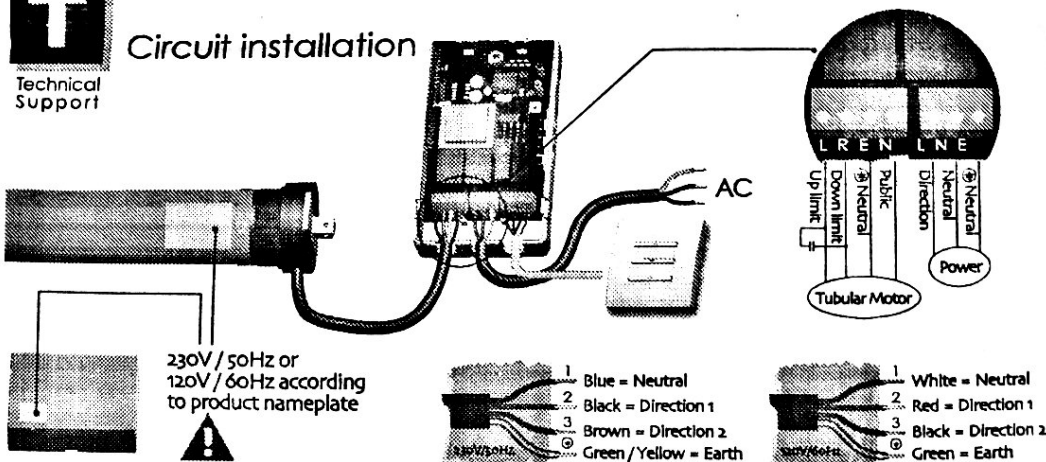

The best installation distance

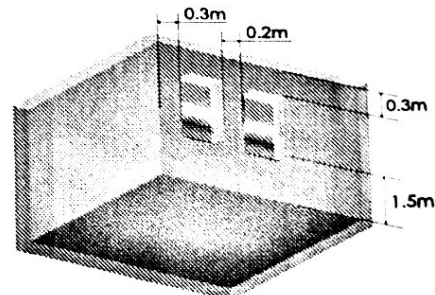

- The shortest distance between receiver and ground >1.5m
- The shortest distance between receiver and roof >0.3m
- The shortest distance between receiver and receiver >0.2m

A

Additional Function

Set up and add emitter

! $T < 10S$ The interval of different button must within 10 seconds of all setting, otherwise the system will restore the original state

! One receiver store 20 emitters channels at most, and one channel of emitter can control 20 receivers at most.

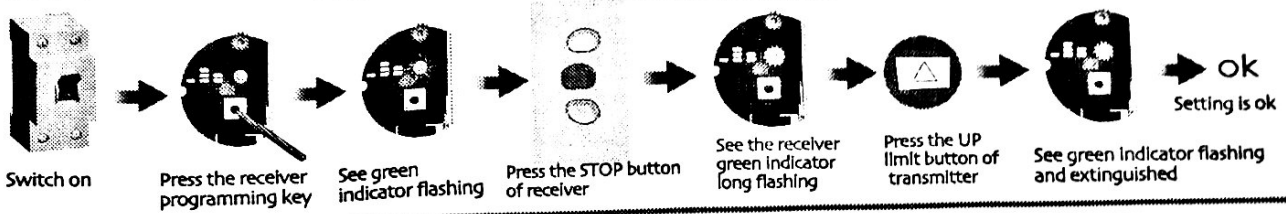

A

Additional Function

Cancel one channel of emitter

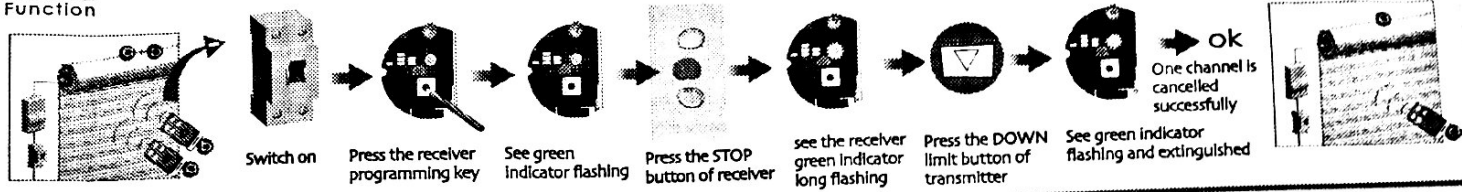

A

Additional Function

Delete all the emitter channels

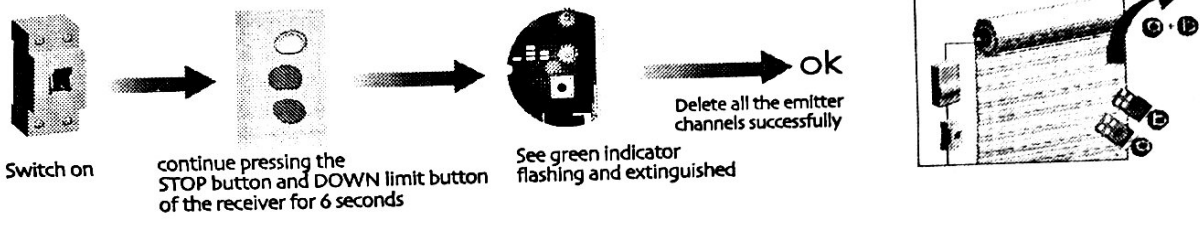

A

Additional Function

Common mode

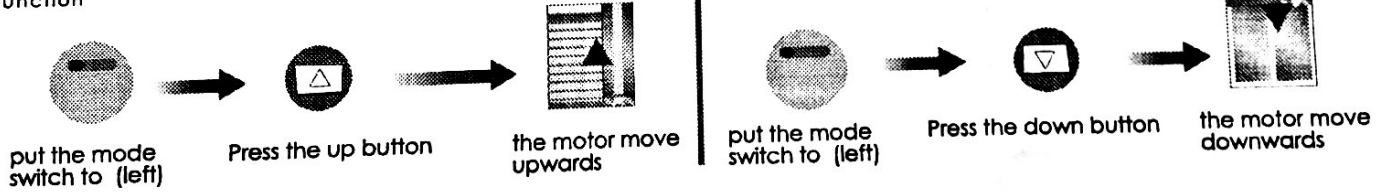

A

Additional Function

Safety mode

! Don't release the down button tubular motor rotate down continuously

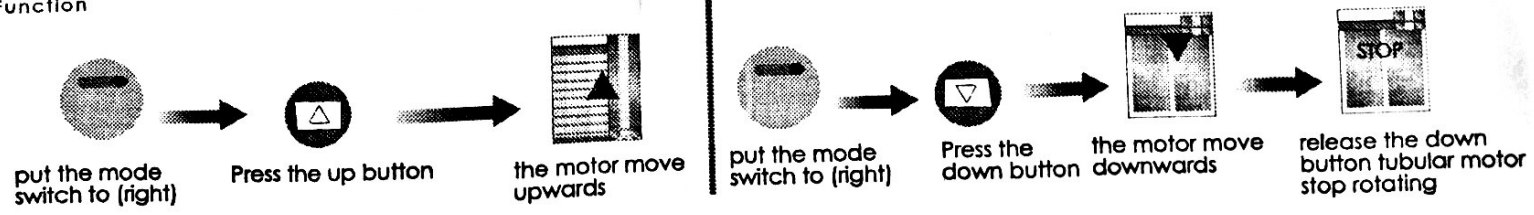



All controls support 433MHz & 868MHz
All controls support 230V/50Hz & 120V/60Hz

Control System

DC301(A) DC319(A,C) DC336(A) Control System

Specification

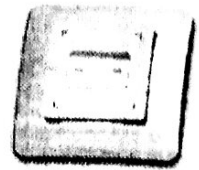
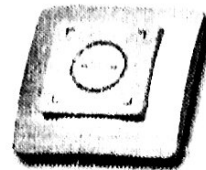
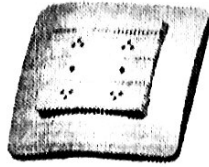
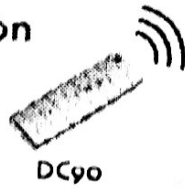

Version No: A/01

Receiver specification

Technical Support

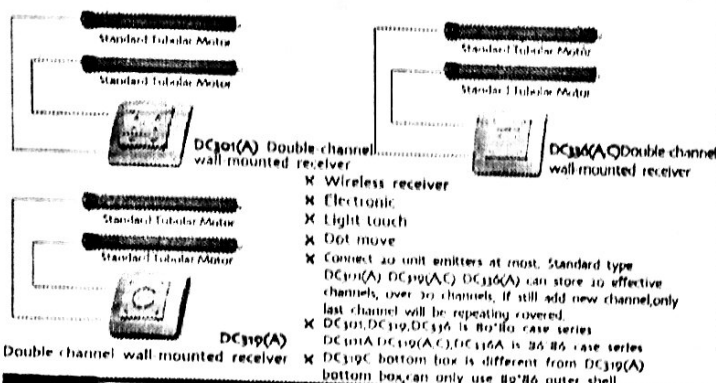

Control Range

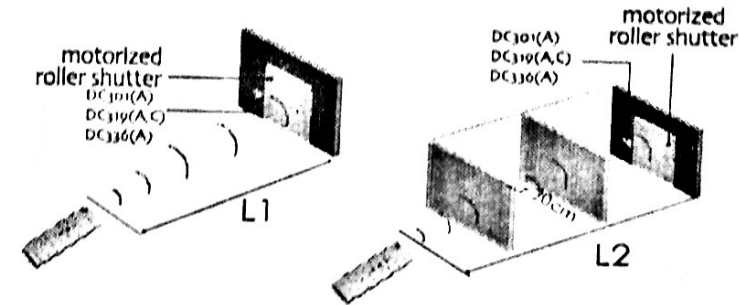

	L1 Open	L2 Partition	Emission frequency
230V/50Hz	200m	35m	433.92MHz
120V/60Hz	200m	35m	

Matchable emitter

Technical Support

5 channel emitter = single channel emitter x 5
one channel of emitter can control 20 receivers at most

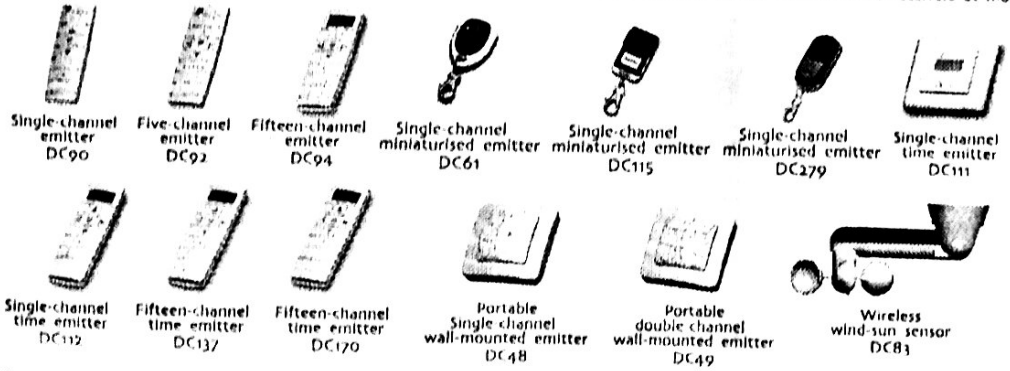

Button specification

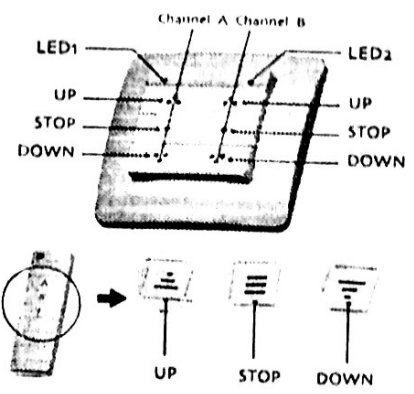

Circuit installation

Technical Support

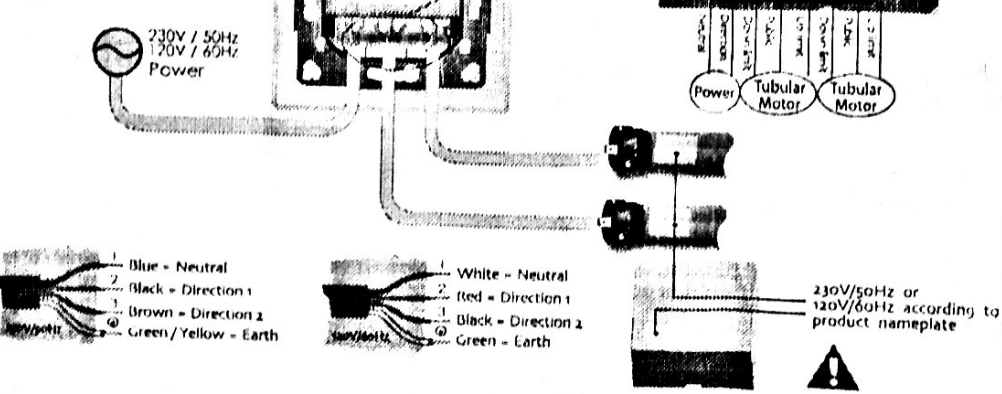

The best installation distance

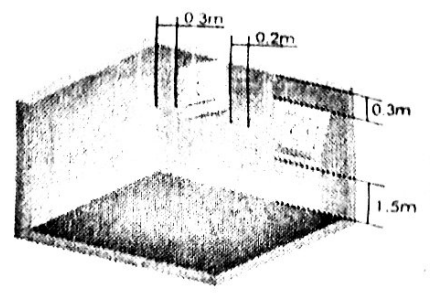

- 1 The shortest distance between receiver and ground > 1.5m
- 2 The shortest distance between receiver and roof > 0.3m
- 3 The shortest distance between receiver and receiver > 0.2m

A Set up and odd emitter

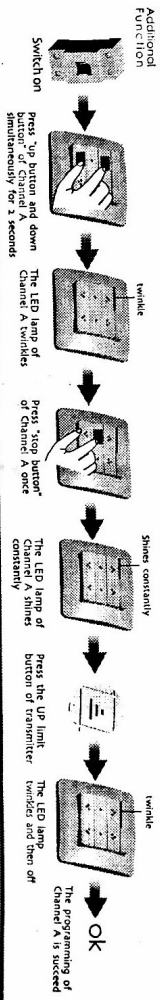

The interval of different button setting, otherwise the system will restore the original state.

One receiver, there 20 emitters channels, emitter can control 20 receivers at most.

A Cancel one channel of emitter

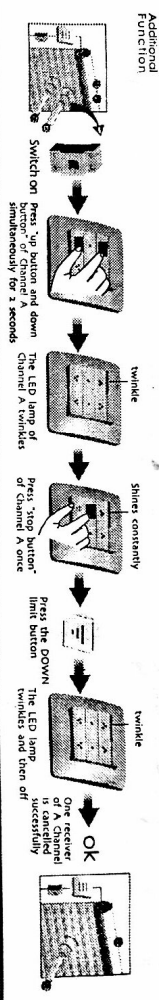

A Dot-move setting

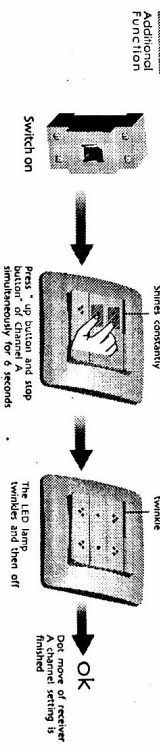

A Delete all the emitter channels

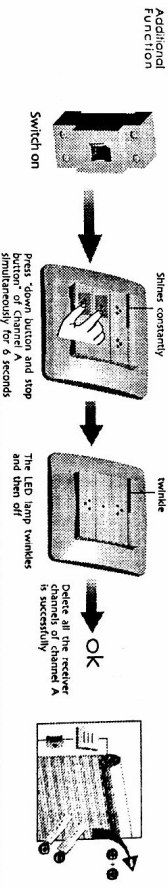

A Up limit setting



When motor doesn't work stop rotating red or white worm with regulator.

A Down limit setting

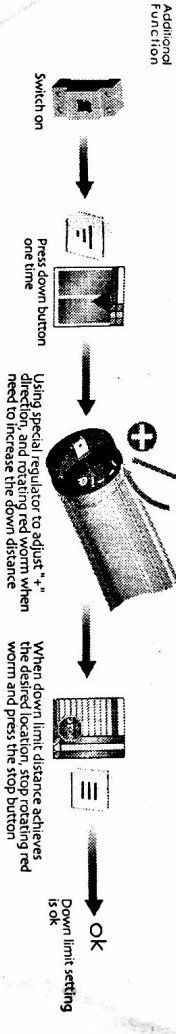

When motor doesn't work stop rotating red or white worm with regulator.



All controls support 433MHz & 868MHz
All controls support 230V/50Hz & 120V/60Hz
Specific parameters to the nameplate shall prevail

Control System

DC138 Control System Specification

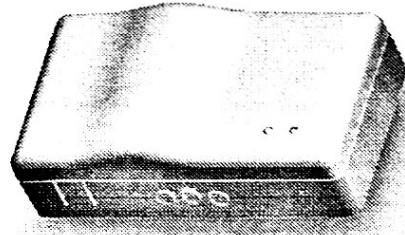

Version No.:A/01

Technical Support

Receiver specification



group control channel match code, delete code, all unworkable. When receiver in the mode of dot function, press up key or down key within two seconds, emitter control the motor working in dot function. If continuous press more than 2 seconds motor will last working.

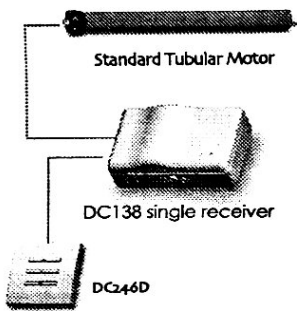

- × Dial reversing function
- × Dial switch over mode
- × Connecting with Electronic switch is available (company matched)
- × standard type DC138 can store 10 effective channels, over 10 channels, if still add new channel, only last channel will be repeating

Control Range

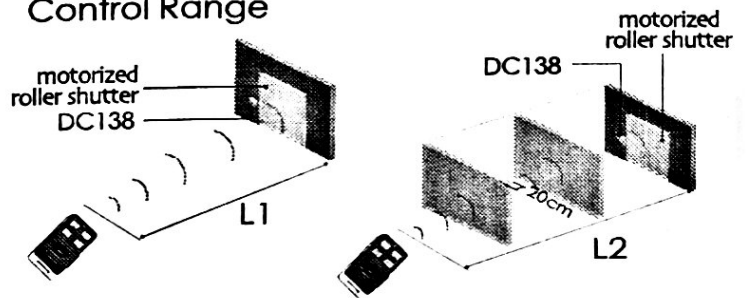

	L1 Open	L2 Partition	Emission frequency
230V/50Hz	200m	35m	433.92MHz
120V/60Hz	200m	35m	

Technical Support

Matchable emitter



5-channel emitter = single channel emitter x 5
one channel of emitter can control 20 receivers at most

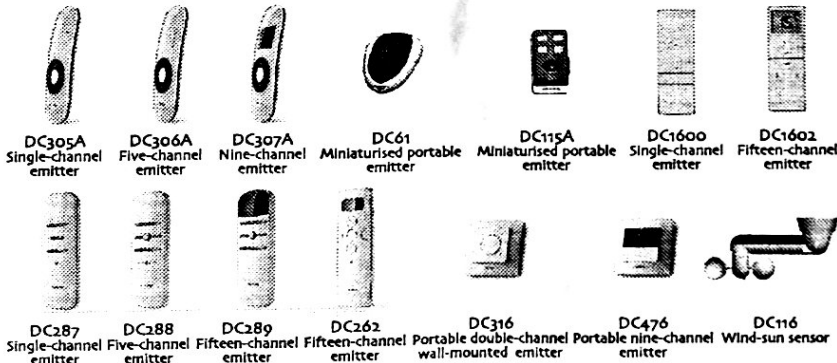

Button specification

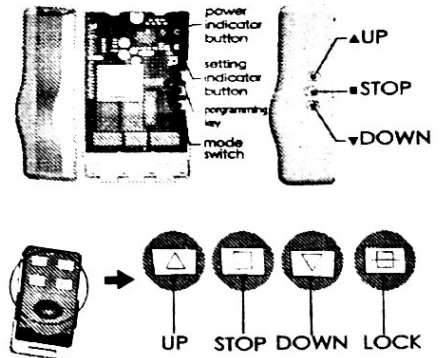

Technical Support

Circuit installation

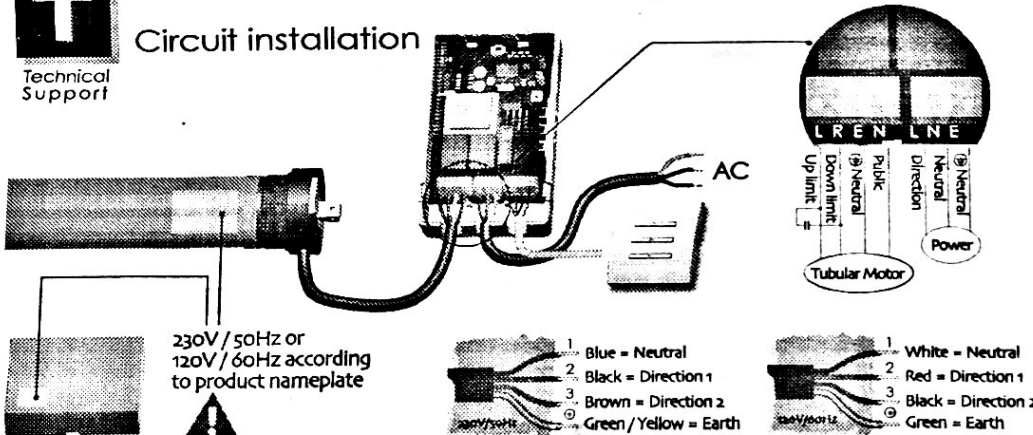

The best installation distance

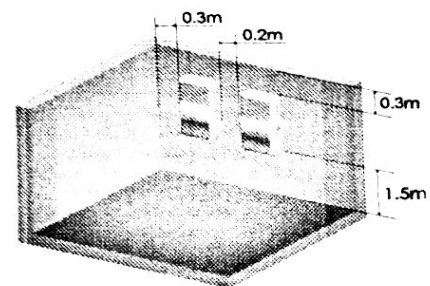

- The shortest distance between receiver and ground $\geq 1.5m$
- The shortest distance between receiver and roof $\geq 0.3m$
- The shortest distance between receiver and receiver $\geq 0.2m$